

TATM



WARNING

This manual is for the exclusive use of dealers accredited by Motrec International Inc. and should not be considered an official document constituting any kind of guarantee for the end user. All information and data are subject to change without notice. All photos contained in this document are for illustrative purposes only and may include non-applicable options.

PARTS:

It is recommended that part numbers be confirmed with Motrec International Inc. before ordering by providing the serial number of the vehicle requiring the part. In some cases, the part installed on the vehicle may differ from the manual depending on the options chosen.

Publication date:

July 1, 2015

Edition for vehicles with
a serial number higher than:

1022722

For additional information,
please contact our customer service:

MOTREC INTERNATIONAL INC.

200 Des PME Street
Sherbrooke, Quebec J1C 0R2
Canada
1-866-846-3558

AVERTISSEMENT

Ce manuel est destiné à l'usage exclusif des concessionnaires accrédités par Motrec International Inc. et n'est pas considéré comme un document officiel pouvant servir de garantie pour l'utilisateur final. Les informations et données sont assujetties à des changements sans préavis. De plus, les photos présentées sont à titre indicatif seulement et pourraient inclure des options non applicables.

PIÈCES:

Il est recommandé de valider les numéros de pièces avec Motrec International Inc. avant de commander, en fournissant le numéro de série du véhicule pour lequel la pièce est requise. Dans certains cas, il est possible que la pièce installée sur le véhicule diffère du manuel en fonction des options choisies.

Date de publication:

1^{er} juillet 2015

Édition destinée aux véhicules ayant
un numéro de série supérieur à:

1022722

Pour toutes informations additionnelles,
contactez notre service à la clientèle:

MOTREC INTERNATIONAL INC.

200, rue des PME
Sherbrooke, Québec J1C 0R2
Canada
1-866-846-3558

MOTREC



TATM



<p>OPERATOR AND MAINTENANCE MANUAL SPARE PARTS LISTS INCLUDED</p>
--

SERIAL NUMBER: 1022722 & UP

Printed in Canada

One Year Limited Warranty

Effective April 25, 2005, MOTREC, Inc. (MOTREC) hereby warrants to the Original Retail Purchaser (Owner) that any of its vehicles shall be free from any defect in materials for a period of 90 DAYS while in the possession of such Original Retail Purchaser. This warranty IS NOT TRANSFERABLE to any subsequent Buyer.

The warranty period is extended to one year or one thousand (1,000) hours, which ever first occurs, on the electric motor, differential (parts that bathe in oil) and the electronic speed controller. MOTREC makes no warranty or representation with respect to the internal combustion engine, tires and batteries, since their respective manufacturers cover such parts. Accessories (light, gage, horn, etc), electrical contacts (switch, solenoid, contactor, relay), diodes & fuses, belts & pulleys, filters & spark plugs, lubricants, brake linings & shoes, brake drums & discs, seals, seats, trim and other items subject to wear are not included in this warranty; nor is any item that in MOTREC sole opinion, shows evidence of neglect, misuse, abuse, collision or alteration.

This warranty shall not apply to normal maintenance requirements as described in the User Manual, and to damages during shipment. The latter is the carrier's responsibility. No compensation will be allowed for delays.

To initiate warranty coverage on any MOTREC vehicle, the Dealer must complete and return the "Sales/Installation Report" to MOTREC within 30 days after delivery to the Original Retail Purchaser; or within 90 days after the delivery date to the Dealer, which ever occurs first. Failure to follow these procedures will result in considering the warranty coverage effective as of the shipment date from the factory.

The defective vehicle must be returned, at the Owner's expense, to an authorised MOTREC Dealer within 30 days after failure. The Owner will not be charged for parts and labour required for warranty repairs, which must be performed by an authorised MOTREC Dealer only. The vehicle will be returned at the owner's expense. The Warranty Claim Forms must be completed and returned with the defective part(s) to MOTREC within 30 days after repair was done. No compensation will be allowed for damages caused by vehicle downtime.

It is the responsibility of the owner of the vehicle to make sure that the driver is properly trained and instructed in the safety features and operation of the vehicle, including vehicle stability, as required by OSHA and ANSI-B56. Operators shall read, understand and follow the safety and operating instructions in MOTREC Manual before driving the vehicle. Operators shall not be permitted to drive the vehicle unless a complete and adequate training has been provided. Driving a vehicle constitutes a hazard. The driver is responsible for the control of the vehicle while driving and must always evaluate and care for all peculiar situations that he or she may meet while driving. The driver assumes the inherent hazards related to this activity. The vehicle is designed for off-road use only. MOTREC disclaims any liability for incidental or consequential damages, to include, but not be limited to, personal injury or property damage arising from vehicle misuse, lack of maintenance or any defect in the vehicle.

It is the responsibility of the Owner of the vehicle to make sure that the service technicians are properly trained as required by OSHA and ANSI-B56. Service technicians shall read, understand and follow instructions in the MOTREC manual before servicing the vehicle. Only qualified and authorized personnel shall be permitted to maintain, repair, adjust and inspect the vehicle.

MOTREC prohibits, and disclaims responsibility for, any vehicle modification altering the weight distribution and stability, increasing the speed or affecting the safety of the vehicle. Such modifications can cause serious personal injury or property damage for which MOTREC disclaims any responsibility.

For Owners that are located outside North America, the warranty period starts the date of shipment from the factory, and the defective parts must be returned at the Owner's expense to MOTREC prior to warranty repair.

TABLE OF CONTENTS

SPARE PARTS	4
BODY	5

SPARE PARTS

BODY

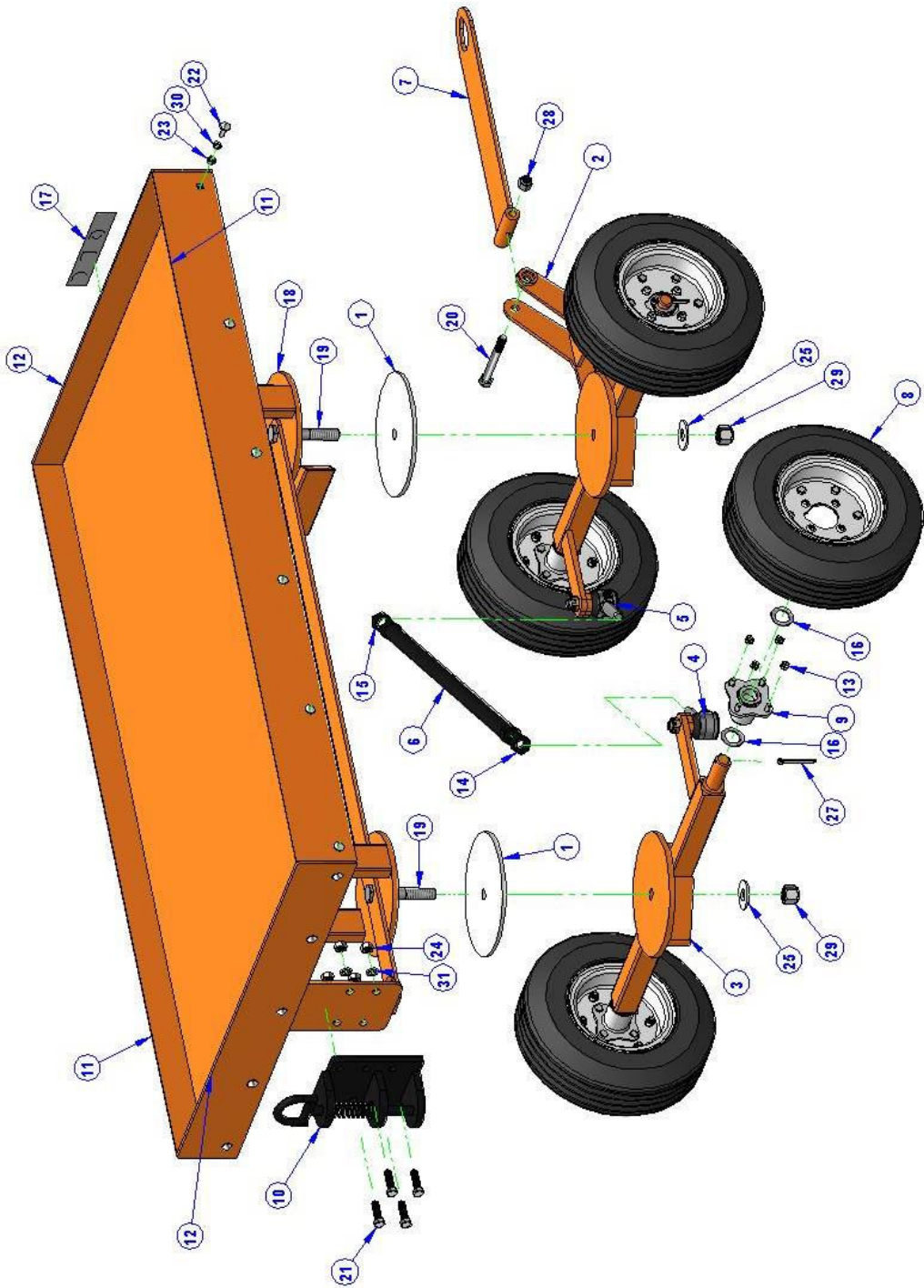

REF.	PART NO.	DESCRIPTION
1	2100001001	PIVOT PLATE
2	2201001001	FRONT AXLE
3	2201001011	REAR AXLE
4	2207000001	ROD END, LEFT HAND
5	2207000002	ROD END, RIGHT HAND
6	2207001001	TIE ROD
7	2219001003	TONG
8	2223000003	PNEUMATIC WHEEL
9	2224001001	HUB
10	2320300001	CLEVIS HITCH & SPRING (OPTIONAL)
11	2333001001	DECK PLATE, RIGHT OR LEFT
12	2333001002	DECK PLATE, FRONT OR REAR
13	2910000004	WHEEL NUT
14	2910000005	NUT, LEFT HAND
15	2910000006	NUT, RIGHT HAND
16	2910001001	SPACER
17	5100250001	MOTREC STICKER
18	6101001001	BODY FRAME
19		BOLT 3/4-NC X 4
20		BOLT 1/2-NC X 4 1/2
21		BOLT 7/16-NC X 1 1/2
22		CARRIAGE BOLT 5/16-NC X 1
23		NUT 5/16-NC
24		NUT 7/16-NC
25		FLAT WASHER 3/4
26		COTTER PIN 1/8 X 1 1/2
27		COTTER PIN 3/16 X 2
28		LOCK NUT 1/2-NC
29		LOCK NUT 3/4-NC
30		LOCK WASHER 5/16
31		LOCK WASHER 7/16